

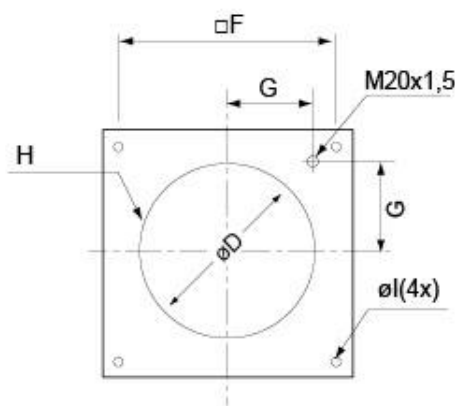

## Abmessungen

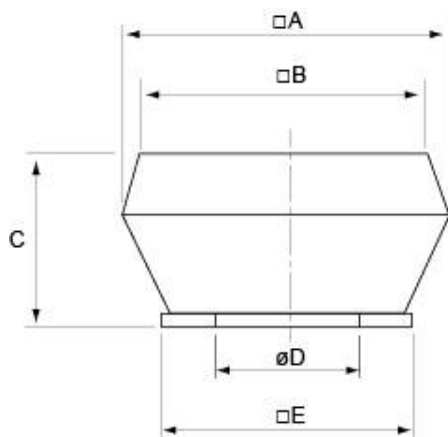

DVS	□A	□B	C	∅D	□E	□F	G	H	∅l
190-225	370	295	170	213	335	245	105	6xM6	10(4x)
310-311	560	470	330	285	435	330	146	6xM6	10(4x)
<b>355-400</b>	<b>720</b>	<b>618</b>	<b>390</b>	<b>438</b>	<b>595</b>	<b>450</b>	<b>200</b>	<b>6xM8</b>	<b>12(4x)</b>
450-500	900	730	465	438	665	535	237	6xM8	12(4x)
560-630	1150	960	560	605	939	750	293	8xM8	14(4x)
710	1350	1185	660	674	1035	840	320	8xM8	14(4x)

\* diameter D refers to screw-hole-circuit H