

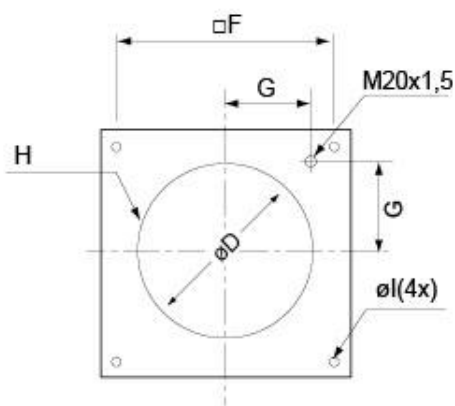

Abmessungen

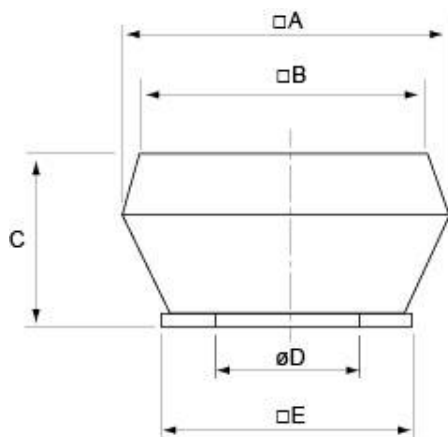

DVSI	□A	□B	C	∅D	□E	□F	G	H	∅l
190-225	497	295	179	213	335	245	105	6xM6	10(4x)
310-311	690	470	369	285	435	330	146	6xM6	10(4x)
355-400	874	618	439	438	595	450	200	6xM8	12(4x)
450-500	968	748	479	438	665	535	237	6xM8	12(4x)
560-630	1315	960	600	605	939	750	293	8xM8	14(4x)
710	1483	1185	729	674	1035	840	320	8xM8	14(4x)

* diameter D refers to screw-hole-circuit H