

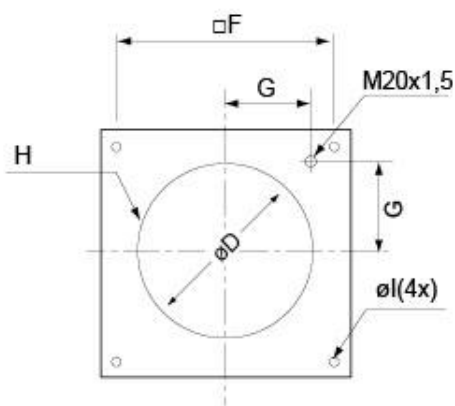

## Abmessungen

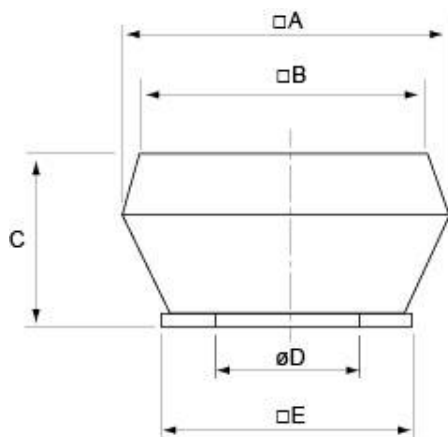

DVSI	□A	□B	C	∅D	□E	□F	G	H	∅l
190-225	497	295	179	213	335	245	105	6xM6	10(4x)
310-311	690	470	369	285	435	330	146	6xM6	10(4x)
355-400	874	618	439	438	595	450	200	6xM8	12(4x)
450-500	968	748	479	438	665	535	237	6xM8	12(4x)
<b>560-630</b>	<b>1315</b>	<b>960</b>	<b>600</b>	<b>605</b>	<b>939</b>	<b>750</b>	<b>293</b>	<b>8xM8</b>	<b>14(4x)</b>
710	1483	1185	729	674	1035	840	320	8xM8	14(4x)

\* diameter D refers to screw-hole-circuit H